



**ROUTE  
INSTRUCTIONS**

**Section 2**

## SECTION 2

You may not start this section until 9.45PM

The roads in this section are a lot more open and there are a few bits where the 'rally' blokes can have a bit of fun.

**NOTE:** Officials will leave their via point at a time known to them. There is adequate time allowed to get there if you keep moving.

**VIA 1.** MRJ 3.5 KM West of MRJ 10.1 KM North of Devlins Bridge.

CLARKES RD  
T1-TREE RD

Exit to generally the North along the dotted road (no trap). DO NOT go straight on at the via.

QUESTION - What are the names on the sign post at this via?

NOTE: From the via point the road is fairly windy and a bit steep in places and a bit rough near the top.

It is good fun but watch out for the right hander on the downhill bit.

**VIA 2.** Yea.

PASSAGE

Enter from South-West.

**VIA 3.** Junction of red and white roads just to the West of Yea.  
Enter from the East.

D9

Exit to the North.

**VIA 4.** Junction of black & white roads 4 KM South-East of Homewood.

A6

## ROUTE INSTRUCTIONS, SECTION 2

### ADDITIONAL INFORMATION RELATING TO VIA 7

#### TO VIA 8

The road you are about to head along from via 7 contains 1 creek crossing (with a Caution board), 3 gates (with Trial Entry sign) and a Quiet Zone board.

The road is predominantly smooth and has some superb open stretches and some great round the trees bits.

Feel free to drive this road however you see fit but watch out for any other traffic (although at midnight I doubt if there will be any).



Watch out for the corner just past the 'Crest' sign.

Back off and drive sensibly once you are past the Quiet Zone board.

It would have been nice to have a timed section along here but under Touring Assembly rules we can't do it.

Have some serious fun.

*Phil, Sue & Hugh*

The directing team.

VIA 5.

PASSAGE

Mapped railway crossing on Goulburn Valley Highway between Homewood & Kerrisdale.  
Enter from East-North-East.

VIA 5A.  
(Bonus)

3 H8

MRJ 2 KM South-South-West of Kerrisdale.  
Enter from East.

This is one for the drivers. Behave yourselves up to the first bend. The road is pretty smooth but watch out for some of the bends.  
There will be an information board placed part way along this road.

VIA 6.

N12

5.9  
MRJ ~~4.5~~ 5.9 KM South-East of Seymour.  
Exit to North-East.

VIA 7.

Junction of red and white roads between Whiteheads Ck & Seymour (Little Map).  
Enter from East-South-East  
Exit to North-North-East.

NOTE: The director used an unmapped road 1.75 KM in length between via 6 & 7.

WD  
USED!  
2K ROAD  
NOT 1.75

VIA 8.

6

MRJ 248465.  
Enter from South-South-West.  
ADVICE: You are coming up the mapped road that runs generally north between the 24 & 25 grid lines.

VIA 9.

C

MRJ 295526.  
Enter from East.  
ADVICE: Use the Avenel town map to get onto the Avenel-Longwood Road.

NEXT PAGE

VIA 10.

PASSAGE

MRJ 275574.

Enter from South-East (unmapped).  
Exit to North-West.

STOPPED  
AT LEAST  
65M FROM INTERSECT

VIA 11.

As per the following map trace.

Enter from the North via shortest mapped route from  
via 10.

AI PASS

WD →

B3

FOLLOWED MAP  
TRACE RATHER THAN SHORTEST

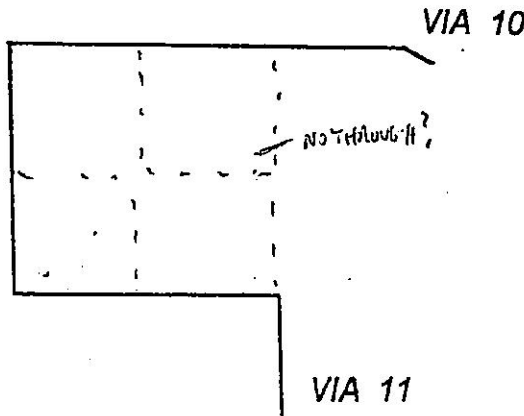

# CONTROL

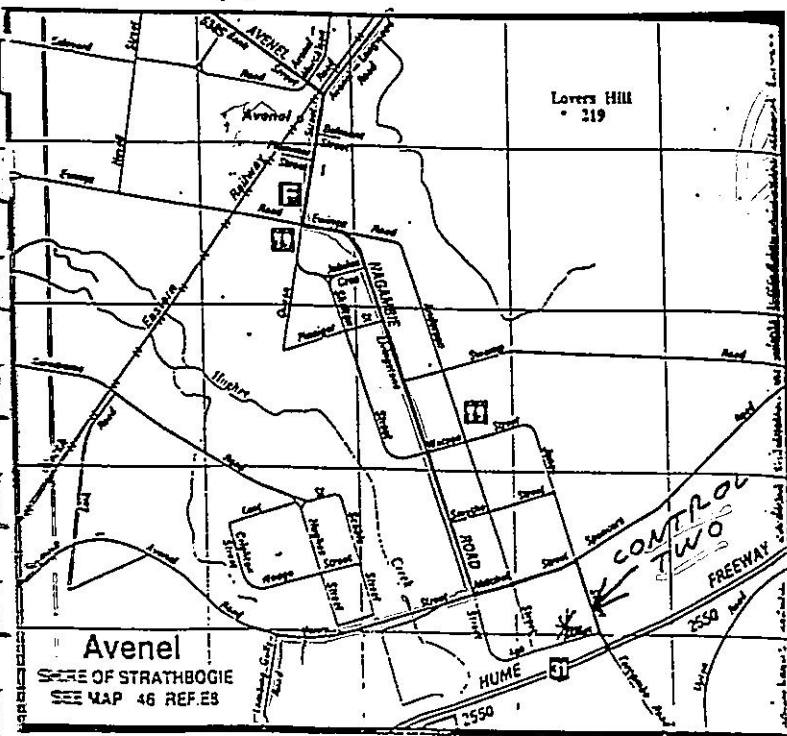

Caltex Roadhouse as shown on  
the map

The control will close at 1.00AM

Section length approx 110 KM.

Make sure you fill your fuel tank  
here as there is no more fuel for  
over 180 KM.

